

1982-1992 CAMARO CASTER/CAMBER PLATE INSTALLATION INSTRUCTIONS

P/N 340040

INSTALLATION:

1. Raise front of car with jack and support with jack stands.
2. Remove front wheels and disconnect sway bar end links.
3. Place jack under A-arm and raise up to compress spring and release tension on strut.
4. Remove upper strut retaining nut and lower jack to allow strut to drop beneath strut tower.
5. Remove stock upper and lower plates.
6. Raise A-arm with jack until strut shaft is ~2 inches through the strut tower hole.

Depending on strut choice the correct spacer kit will vary. Please see strut spacer sheet for proper spacer installation.

Racecraft Inc. caster camber plates also have a built-in coarse camber adjustment. The top of the strut can be moved 1/2" by flipping the bearing plate 180°. This is useful where A-arms are shorter than stock and the strut needs moved towards the center of the car. This also aids in plate placement for the extra mounting points.

7. Determine correct orientation of bearing plates and install on struts as shown below, using correct bushing kit. Tighten strut retaining nut. Make sure spacers are properly inserted into spherical bearing!
8. From below, insert stud plate through strut tower and loosely install hardware.
9. Move plates through the full range of adjustment and check for tight spots. If tight spots exist, remove plates and open up strut tower slots with a file or die grinder.
10. Position plates in a neutral alignment position and tighten all hardware securely.
11. Reconnect sway bar end links and reinstall front wheels.
12. After alignment, use a 5/16" drill bit and drill strut towers for extra mounting holes. Install supplied hardware.

*** DO NOT DRIVE VEHICLE BEFORE BEING REALIGNED! ***

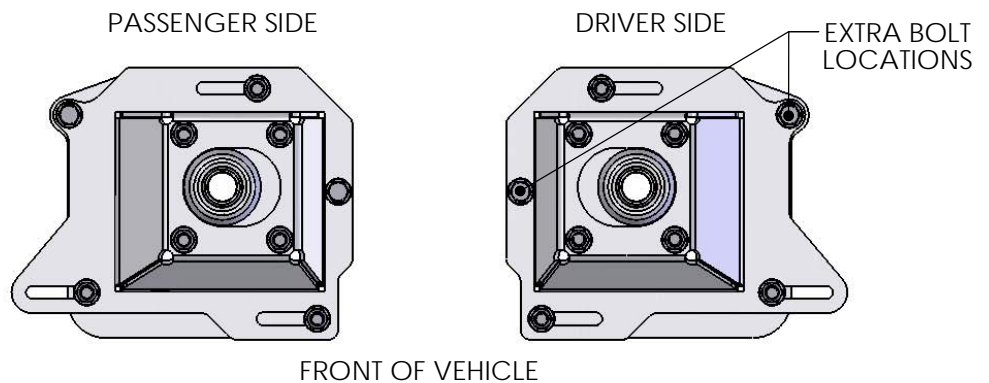
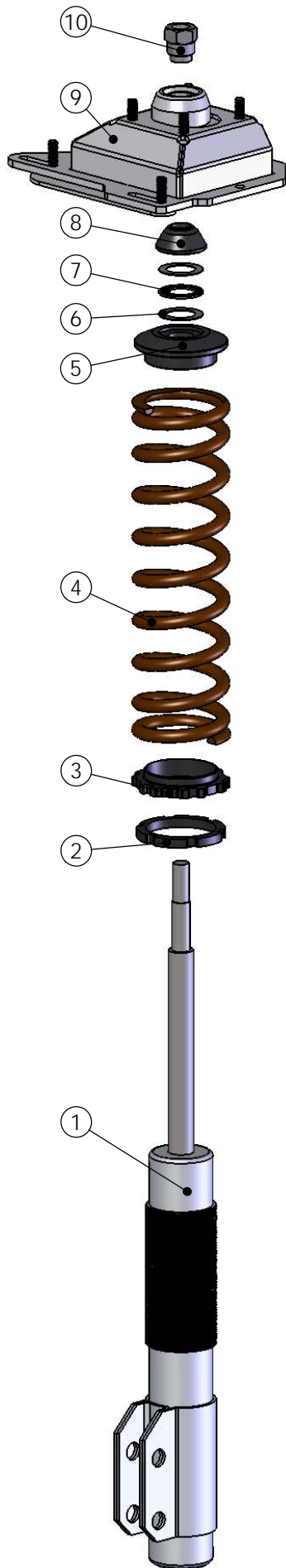

ITEM	DESCRIPTION	QTY
1	STRUT	1
2	ADJUSTING JAM NUT	1
3	SPRING SEAT NUT	1
4	12" COIL OVER SPRING	1
5	TOP SPRING SEAT	1
6	THRUST WASHER	2
7	THRUST BEARING	1
8	STRUT HAT	1
9	CASTER CAMBER PLATE	1
10	STRUT NUT	1

Racecraft Inc.
www.racecraft.com